

The background of the slide is a blue gradient with a subtle, wavy pattern, resembling water or a sky with light clouds. The text is centered and reads "REGIONAL PUBLIC SAFETY TRAINING CENTER" in white, uppercase, sans-serif font.

# REGIONAL PUBLIC SAFETY TRAINING CENTER

# TRAINING PROPERTY STATUS

- Original property was purchased and closed on 6/10/08
- 30.22 acres
- 21 acres of buildable area
- Zoned R-5
- Located between Paradise Lake Road and Echo Lake Road adjacent to SR 522
- Purchase price of \$925,000.00

- Second site is currently under negotiation.
- 20 acres
- Zoned R5
- Current offer \$850,000.00
- Owners have agreed to sell to fire district.
- Group 4 is standing by to conduct pre-closing studies.

# Area Map



# Utilities

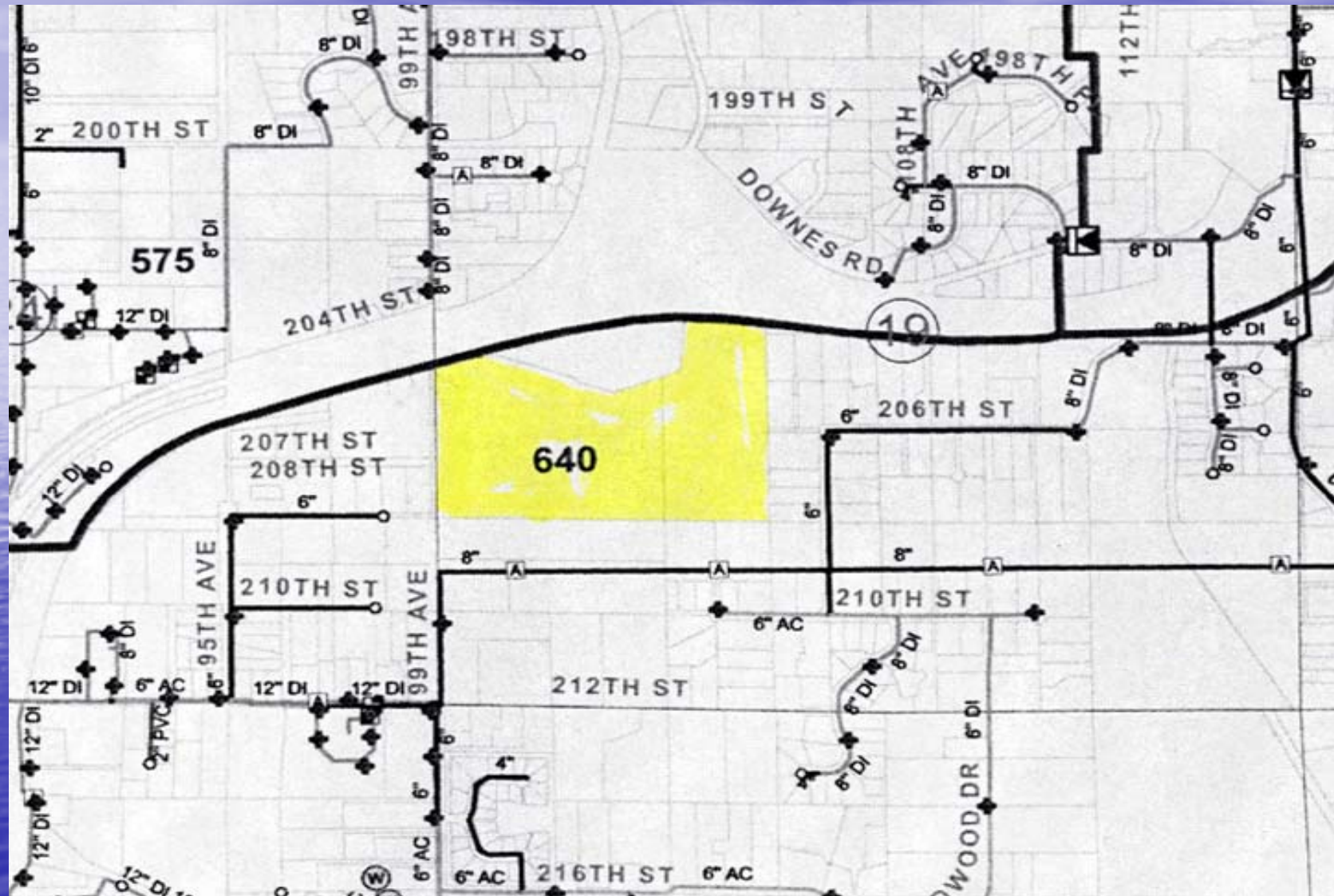

# NEXT STEPS

- Finalize additional 20 acres
- **Identify partnerships and obtain commitments**
- Establish planning group
- Appoint a project manager
- Publish Request for Proposal
- Select an architect / consultant
- Develop Interlocal Agreement

- Identify & market funding sources
- Master plan the site and primary buildings/training props
- Design phase
- Permit phase
- Site development

- 
- Construction phase
  - Operate and maintain facility